

QUICK SET-UP



C2-2200 Unit
C2-2250 Unit
C2-2350 Unit

Congratulations on purchasing your C2-2000 series unit. Use this card as a quick setup guide to help you get started and get a basic feel for the powerful toolset of features the unit contains. To get the most out of and fully understand the unit, please refer to the C2-2000 Series Manual.

Please bear in mind this card is for use with the C2-2000 series, not just one unit. Some options and connectors may vary or differ from unit to unit.



Contents & Connecting

First things first, before you even begin to use the unit, unpack it from its packaging and make sure you have all of the following:

- 1 Infra-red remote control
- 1 Operations Manual
- 1 Composite video (CV) Cable, 6' (2m) BNC to BNC
- 1 RS-232 9D plug to socket, 6' (2m)
- 1 HD15 to HD15 Cable, 6' (2m)
- 1 AC Power adaptor (optional)
- 1 DVI I/O Cable, 6' (2m) DVI-D

Included with SDI-equipped units only:
 1 SDI Cable, 6' (2m) Zplus BNC to BNC

If any items are missing or defective, contact your supplier. If you are unable to resolve the problem with your supplier, contact TV One via the web at:

<http://www.tvone.com/support>

for prompt replacement.

Once you have connected all the required equipment as per the diagram you are ready to unleash the full potential of the unit.

On turning on the unit, provided all the desired connections have been made properly, you will see a PC loop through image on the screen. Please note for some units in the series the image may be scaled up to 1024 x 768.

To begin using the functions of your unit please consult the manual supplied which will cover each area of the unit in greater detail.

Your unit is now ready.

Games Console or other source

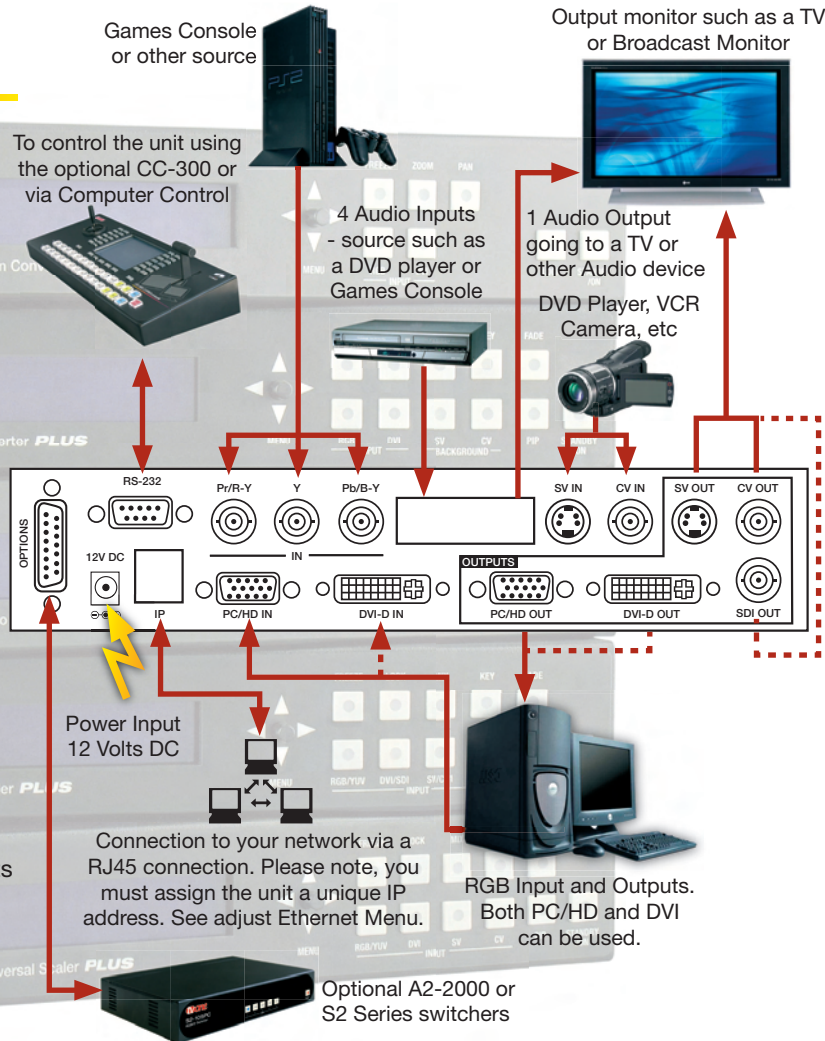

To control the unit using the optional CC-300 or via Computer Control

4 Audio Inputs - source such as a DVD player or Games Console

Output monitor such as a TV or Broadcast Monitor

1 Audio Output going to a TV or other Audio device
 DVD Player, VCR
 Camera, etc

Power Input
 12 Volts DC

Connection to your network via a RJ45 connection. Please note, you must assign the unit a unique IP address. See adjust Ethernet Menu.

RGB Input and Outputs. Both PC/HD and DVI can be used.

Optional A2-2000 or S2 Series switchers